



Overview



Legend

-  Corporate Limits
-  Political Township
-  Sections
-  Blocks
-  Parcels
-  Road Centerlines
- 2019 Sales

Parcel ID	84-06-26-327-005.000-002	Alternate ID	118-06-26-327-005	Owner Address	WILLHAM MARK A & LYNDAM
Sec/Twp/Rng	26	Class	Res 1 fam dwelling platted lot		1135 BROOKS AVE
Property Address	1135 BROOKS AVE TERRE HAUTE	Acreeage	n/a		TERRE HAUTE, IN 47803
Neighborhood	118543 - HARRISON				
District	002 HARRISON				
Brief Tax Description	JOHN S EVANS SUB 2004011987 2004009484 D-427/379 26-12-9 LOT 19 <i>(Note: Not to be used on legal documents)</i>				

Date created: 10/11/2019
Last Data Uploaded: 10/10/2019 8:52:33 PM

Developed by  **Schneider**
GEOSPATIAL

Summary - Assessor's Office

Parcel ID 84-06-26-327-005.000-002
Tax ID 118-06-26-327-005
Section Plat 26
Routing Number
Neighborhood 118543 - HARRISON
Property Address 1135 Brooks Ave
 Terre Haute, IN 47803
Legal Description JOHN S EVANS SUB 2004011987 2004009484 D-427/379 26-12-9 LOT 19
(Note: Not to be used on legal documents)
Acreage N/A
Class 510 - Res 1 fam dwelling platted lot
Tax District/Area 002 - HARRISON

[View Map](#)



Owner - Auditor's Office

Deeded Owner
 Willham Mark A & Lynda M
 1135 BROOKS AVE
 TERRE HAUTE, IN 47803

Site Description - Assessor's Office

Topography
Public Utilities
Street or Road
Neigh. Life Cycle
Legal Acres 0
Legal Sq Ft 0

Land - Assessor's Office

Land Type	Soil ID	Actual Front	Acreage	Effect. Front	Effect. Depth	Prod Factor	Depth Factor	Meas Sq Ft	Base Rate	Adj Rate	Extended Value	Influ. Factor	Value
FRONT LOT		80.000	0.000	80.000	145.000	0.00	1.04		91.00	94.64	7,570.00	L 7%	8,100.00

Land Detail Value Sum 8,100.00

Residential Dwellings - Assessor's Office

Card 01
 Residential Dwelling 1
 Occupancy
 Story Height 1.0
 Roofing Material: Asphalt shingles
 Attic None
 Basement Type Full
 Basement Rec Room 960 sqft.
 Finished Rooms 5
 Bedrooms 3
 Family Rooms 0
 Dining Rooms 0
 Full Baths 1; 3-Fixt.
 Half Baths 0; 0-Fixt.
 4 Fixture Baths 0; 0-Fixt.
 5 Fixture Baths 0; 0-Fixt.
 Kitchen Sinks 1; 1-Fixt.
 Water Heaters 1; 1-Fixt.
 Central Air Yes
 Primary Heat Central Warm Air
 Extra Fixtures 0
 Total Fixtures 5
 Fireplace No
 Features None
 Porches and Decks CONCP 176
 Masonry Stoop 35
 Masonry Stoop 16
 CONCP 147
 Masonry Stoop 16

Yd Item/Spc Fture/Outbldg WOOD FRAME 288 SF
 WOOD FRAME DETACHED GARAGE 352 SF

Last Updated 3/7/2003

Construction	Floor	Base Area (sf)	Fin. Area (sf)
	1.0	960	960
Concrete block	B	960	0
	Total	1920	960

Improvements - Assessor's Office

Card 01

ID	Use	Stry Hgt	Const Type	Grade	Year Const	Eff Year	Cond	Base Rate	Features	Adj Rate	Size/ Area	Cost Value	Phys Depr	Obsol Depr	Mrkt Adj	% Comp	Value
D	DWELL	1		C-1	1957	1957	AV	0.00		0	960	99440	42	0	107	100	61700
G01	ICP		WOOD FRAME		0	0	AV	13.77		13.77	12 x 24	3970	0	0	107	100	0
01	DETGAR		WOOD FRAME	D+2	1951	1951	AV	34.48		28.86	16 x 22	10160	47	0	107	100	5800

Transfer History - Assessor's Office

Date	Owner 1	Owner 2	Book & Page	Amount
5/19/2004	WILLHAM MARK A		2004/011987	\$0.00
4/27/2004	WILLHAM MARK A & LYNDA M WILLHAM		2004/009484	\$0.00
5/23/1991	BLAND BETTY		427/379	\$0.00
2/23/1989	LINDSAY FORREST W & LOIS B		417/347	\$0.00
8/11/1979	MOORE DAVID E & MARYLOU		379/742	\$0.00
8/9/1978	JOVI FRANK G		375/350-2	\$0.00

Valuation - Assessor's Office

Assessment Year		01/01/2019	01/01/2018	01/01/2017	01/01/2016	03/01/2015
Reason for Change		ANN ADJ	ANN ADJ	ANN ADJ	ANN ADJ	ANN ADJ
VALUATION (Assessed Value)	Land	\$8,100	\$7,800	\$15,000	\$15,000	\$14,900
	Improvements	\$67,500	\$65,000	\$65,400	\$65,400	\$63,300
	Total	\$75,600	\$72,800	\$80,400	\$80,400	\$78,200
VALUATION (True Tax Value)	Land	\$8,100	\$7,800	\$15,000	\$15,000	\$14,900
	Improvements	\$67,500	\$65,000	\$65,400	\$65,400	\$63,300
	Total	\$75,600	\$72,800	\$80,400	\$80,400	\$78,200

Deductions - Auditor's Office

Tax Year	Deduction Type	Amount
2018 Pay 2019	Mortgage	\$3,000.00
2018 Pay 2019	Homestead - Supplemental	\$10,192.00

Tax Year	Deduction Type	Amount
2018 Pay 2019	Homestead Credit/ Standard	\$43,680.00
2017 Pay 2018	Mortgage	\$3,000.00
2017 Pay 2018	Homestead - Supplemental	\$12,390.00
2017 Pay 2018	Homestead Credit/ Standard	\$45,000.00
2016 Pay 2017	Mortgage	\$3,000.00
2016 Pay 2017	Homestead - Supplemental	\$10,486.00
2016 Pay 2017	Homestead Credit/ Standard	\$44,940.00
2015 Pay 2016	Mortgage	\$3,000.00
2015 Pay 2016	Homestead - Supplemental	\$10,206.00
2015 Pay 2016	Homestead Credit/ Standard	\$43,740.00
2014 Pay 2015	Mortgage	\$3,000.00
2014 Pay 2015	Homestead - Supplemental	\$10,164.00
2014 Pay 2015	Homestead Credit/ Standard	\$43,560.00
2013 Pay 2014	Mortgage	\$3,000.00
2013 Pay 2014	Homestead - Supplemental	\$9,968.00
2013 Pay 2014	Homestead Credit/ Standard	\$42,720.00
2012 Pay 2013	Mortgage	\$3,000.00
2012 Pay 2013	Homestead - Supplemental	\$9,870.00
2012 Pay 2013	Homestead Credit/ Standard	\$42,300.00
2011 Pay 2012	Mortgage	\$3,000.00
2011 Pay 2012	Homestead - Supplemental	\$11,445.00
2011 Pay 2012	Homestead Credit/ Standard	\$45,000.00
2010 Pay 2011	Mortgage	\$3,000.00
2010 Pay 2011	Homestead - Supplemental	\$10,122.00
2010 Pay 2011	Homestead Credit/ Standard	\$43,380.00
2009 Pay 2010	Mortgage	\$3,000.00
2009 Pay 2010	Homestead - Supplemental	\$10,388.00
2009 Pay 2010	Homestead Credit/ Standard	\$44,520.00
2008 Pay 2009	Mortgage	\$3,000.00
2008 Pay 2009	Homestead - Supplemental	\$10,472.00
2008 Pay 2009	Homestead Credit/ Standard	\$44,880.00
2007 Pay 2008	Mortgage	\$3,000.00
2007 Pay 2008	Homestead Credit/ Standard	\$34,250.00
2006 Pay 2007	Mortgage	\$3,000.00
2006 Pay 2007	Homestead Credit/ Standard	\$34,900.00

Charges (2012-2018) - Auditor's Office

Delinquent payments made after the fall due date will still show due in the year they were originally assessed. If paid, payment will show in the next tax year.

Detail:

Tax Year	Type	Category	Description	Amount	Bal Due
2018 Pay 2019	Property Tax Detail	Tax	1st Installment Tax	\$330.16	\$0.00
2018 Pay 2019	Property Tax Detail	Tax	2nd Installment Tax	\$330.16	\$330.16
2017 Pay 2018	Property Tax Detail	Tax	1st Installment Tax	\$402.00	
2017 Pay 2018	Property Tax Detail	Tax	2nd Installment Tax	\$402.00	
2016 Pay 2017	Property Tax Detail	Tax	1st Installment Tax	\$438.73	
2016 Pay 2017	Property Tax Detail	Tax	2nd Installment Tax	\$438.73	
2015 Pay 2016	Property Tax Detail	Tax	1st Installment Tax	\$415.73	
2015 Pay 2016	Property Tax Detail	Tax	2nd Installment Tax	\$415.73	
2014 Pay 2015	Property Tax Detail	Tax	1st Installment Tax	\$405.50	
2014 Pay 2015	Property Tax Detail	Tax	2nd Installment Tax	\$405.50	
2013 Pay 2014	Property Tax Detail	Tax	1st Installment Tax	\$394.70	
2013 Pay 2014	Property Tax Detail	Tax	2nd Installment Tax	\$394.70	
2012 Pay 2013	Property Tax Detail	Tax	1st Installment Tax	\$382.70	
2012 Pay 2013	Property Tax Detail	Tax	2nd Installment Tax	\$382.70	
2011 Pay 2012	Property Tax Detail	Tax	1st Installment Tax	\$422.67	
2011 Pay 2012	Property Tax Detail	Tax	2nd Installment Tax	\$422.67	

Total:

Tax Year	Amount	Bal Due
2018 Pay 2019	\$660.32	\$330.16
2017 Pay 2018	\$804.00	
2016 Pay 2017	\$877.46	
2015 Pay 2016	\$831.46	
2014 Pay 2015	\$811.00	
2013 Pay 2014	\$789.40	
2012 Pay 2013	\$765.40	
2011 Pay 2012	\$845.34	

Photos - Assessor's Office



Sketches - Assessor's Office

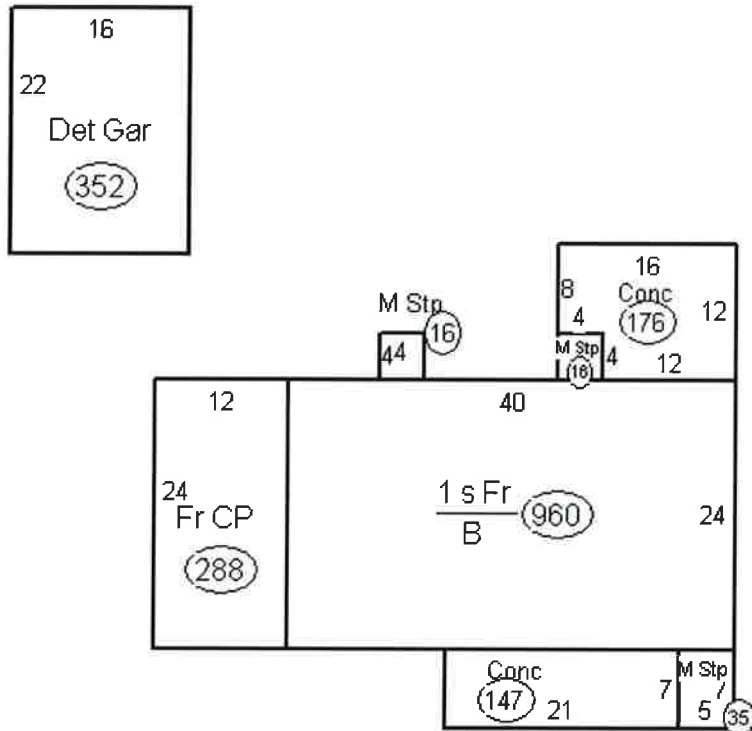

Map



No data available for the following modules: Farm Land Computations - Assessor's Office, Transfer Recording - Auditor's Office, Homestead Allocations - Assessor's Office, Payments (2010-2018) - Treasurer's Office, Exemptions - Auditor's Office.

The information on this website represents Schneider data from a third party. It is not intended to be used for legal or financial purposes. The information is provided for informational purposes only. It is not intended to be used for legal or financial purposes. The information is provided for informational purposes only. It is not intended to be used for legal or financial purposes.

[User Privacy Policy](#)
[GDPR Privacy Notice](#)



Last Data Upload: 10/10/2019, 8:52:33 PM

Version 2.3.8