



Overview



Legend

- Parcels
- Lots
- Highways
- Corporate Limits
- County Area
- Sections

Parcel ID	77-07-33-114-028.000-012	Alternate ID	07-33-114-028.000-012	Owner Address	Anderson, James E et ux Twila A
Sec/Twp/Rng	n/a	Class	1 Family Dwell - Platted Lot		PO Box 1290
Property Address	414 W THOMPSON	Acreage	n/a		Glenwood AR 71943
	SULLIVAN				

District SULLIVAN CITY

Brief Tax Description Plat A Lot 18, Plat A W1/2 Lot 19

(Note: Not to be used on legal documents)

Date created: 7/12/2017
Last Data Uploaded: 4/4/2017 10:16:07 PM



Summary

Parcel ID 77-07-33-114-028.000-012
Alternate ID 07-33-114-028.000-012
Property Address 414 W THOMPSON
 SULLIVAN, IN 47882
Brief Tax Description Plat A Lot 18, Plat A W1/2 Lot 19
 (Note: Not to be used on legal documents)
Class 510: 1 Family Dwell - Platted Lot



Owner

Anderson, James E etux Twila A
 PO Box 1290
 4549 Everest Dr S
 Glenwood, AR 71943

Site Description

Topography: Flat
Public Utilities: All
Street or Road: Paved, Sidewalk
Area Quality Static
Parcel Acreage:

Transfer History (Auditor)

Date	Transfer From	Instrument	Book	Page	Doc Nbr
8/25/2009	Heap, George E etux Summers	WD			2009002910

Taxing District

County: Sullivan
Township: HAMILTON TOWNSHIP
State District 012 SULLIVAN CITY
Local District: 012
School Corp: SOUTHWEST
Neighborhood: 51249-012 51249-012

Land

Land Type	Soil ID	Act Front.	Eff. Depth	Size	Rate	Adj. Rate	Ext. Value	Infl. %	Value
(F) FRONT LOT		93	175	93x175	\$120.00	\$114.00	\$10,602.00	\$0.00	\$10,600.00

Residential Dwellings

Description	Single-Family 1
Story Height	1
Style	BUNGALOW
Finished Area	2891
# Fireplaces	1
Heat Type	Central Warm Air
Air Cond	0
Bedrooms	3
Living Rooms:	0
Dining Rooms:	0
Family Rooms:	0
Finished Rooms:	6
Full Baths	2
Full Bath Fixtures	6
Half Baths	0
Half Bath Fixtures	0
Kitchen Sinks	1
Water Heaters	1
Add Fixtures	0

Floor	Construction	Base	Finish
1	Wood Frame	2891	2891
B		722	0
C		2169	0

Improvements

Descr	PC	Grade	Year Built	Eff Year	Cond	LCM	Size	Nbhd Factor	Mrkt Factor
Single-Family 1	100	C	1895	1950	A	1.01	2891	0.96	0
Car Shed 1	100	D	1962	1962	A	1.01	396	0.96	0
Utility Shed 1	100	D	1962	1962	A	1.01	1	0.96	0
Utility Shed 1	100	D	1940	1940	A	1.01	224	0.96	0

Transfer History (Assessor)

Date	New Owner	Doc ID	Book/Page	Sale Price
8/25/2009	Anderson, James E etux Twila A			\$0.00
8/25/2009	ANDERSON JAMES E ETUX TWILA A			\$82,000.00

Valuation

Assessment Year	2016	2015	2014	2013	2013 (2)
Reason	Annual Adjustment	Annual Adjustment	Annual Adjustment	Annual Adjustment	Miscellaneous
As Of Date	9/9/2016	9/29/2015	7/18/2014	12/18/2013	2/20/2013
Land	\$10,600	\$10,600	\$10,600	\$10,600	\$10,600
Land Res (1)	\$10,600	\$10,600	\$10,600	\$10,600	\$10,600
Land Non Res (2)	\$0	\$0	\$0	\$0	\$0
Land Non Res (3)	\$0	\$0	\$0	\$0	\$0
Improvement	\$99,800	\$94,500	\$87,500	\$86,200	\$90,300
Imp Res (1)	\$98,700	\$93,500	\$86,600	\$85,300	\$89,300
Imp Non Res (2)	\$0	\$0	\$0	\$0	\$0
Imp Non Res (3)	\$1,100	\$1,000	\$900	\$900	\$1,000
Total	\$110,400	\$105,100	\$98,100	\$96,800	\$100,900
Total Res (1)	\$109,300	\$104,100	\$97,200	\$95,900	\$99,900
Total Non Res (2)	\$0	\$0	\$0	\$0	\$0
Total Non Res (3)	\$1,100	\$1,000	\$900	\$900	\$1,000

Exemptions

Type	Description	2013 Pay 2014
Homestead	Homestead Supple	\$17,815.00
Mortgage	MTG_EX	\$3,000.00
Homestead	STD_EX	\$45,000.00

Homestead Assessments

	2015 Pay 2016	2014 Pay 2015	2013 Pay 2014
Land	\$10,600.00	\$10,600.00	\$10,600.00
Res Land	\$0.00	\$0.00	\$10,600.00
Improve	\$94,500.00	\$87,500.00	\$86,200.00
Res Improve	\$0.00	\$0.00	\$85,300.00

Tax History

	2015 Pay 2016	2014 Pay 2015	2013 Pay 2014	2012 Pay 2013
+ Spring Tax	\$1,056.00	\$985.50	\$493.00	\$514.50
+ Spring Penalty	\$0.00	\$0.00	\$49.30	\$0.00
+ Spring Annual	\$0.00	\$0.00	\$24.73	\$0.00
+ Fall Tax	\$1,056.00	\$985.50	\$493.00	\$514.50
+ Fall Penalty	\$0.00	\$0.00	\$0.00	\$12.36
+ Fall Annual	\$0.00	\$0.00	\$0.00	\$0.00
+ Delq NTS Tax	\$0.00	\$0.00	\$247.30	\$554.00
+ Delq NTS Pen	\$0.00	\$0.00	\$24.73	\$55.40
+ Delq TS Tax	\$0.00	\$0.00	\$0.00	\$545.00
+ Delq TS Pen	\$0.00	\$0.00	\$0.00	\$63.90
+ Other Assess	\$0.00	\$0.00	\$243.40	\$214.86
+ Advert Fee	\$0.00	\$0.00	\$0.00	\$0.00
+ Tax Sale Fee	\$0.00	\$0.00	\$0.00	\$0.00
+ NSF Fee	\$0.00	\$0.00	\$0.00	\$0.00
PTRC	\$0.00	\$0.00	\$0.00	\$0.00
HMST Credit	\$0.00	\$0.00	\$0.00	\$0.00
Circuit Breaker	\$1,702.71	\$1,647.32	\$135.88	\$209.33
Over 65 CB	\$0.00	\$0.00	\$0.00	\$0.00
= Charges	\$2,112.00	\$1,971.00	\$1,575.46	\$2,474.52
- Surplus Transfer	\$0.00	\$0.00	\$0.00	\$0.00
- Credits	(\$2,112.00)	(\$1,971.00)	(\$1,575.46)	(\$2,000.00)
= Total Due	\$0.00	\$0.00	\$0.00	\$474.52

Photos



77-07-33-114-028.000-012 11/21/2014



77-07-33-114-028.000-012 11/21/2014

Sketches

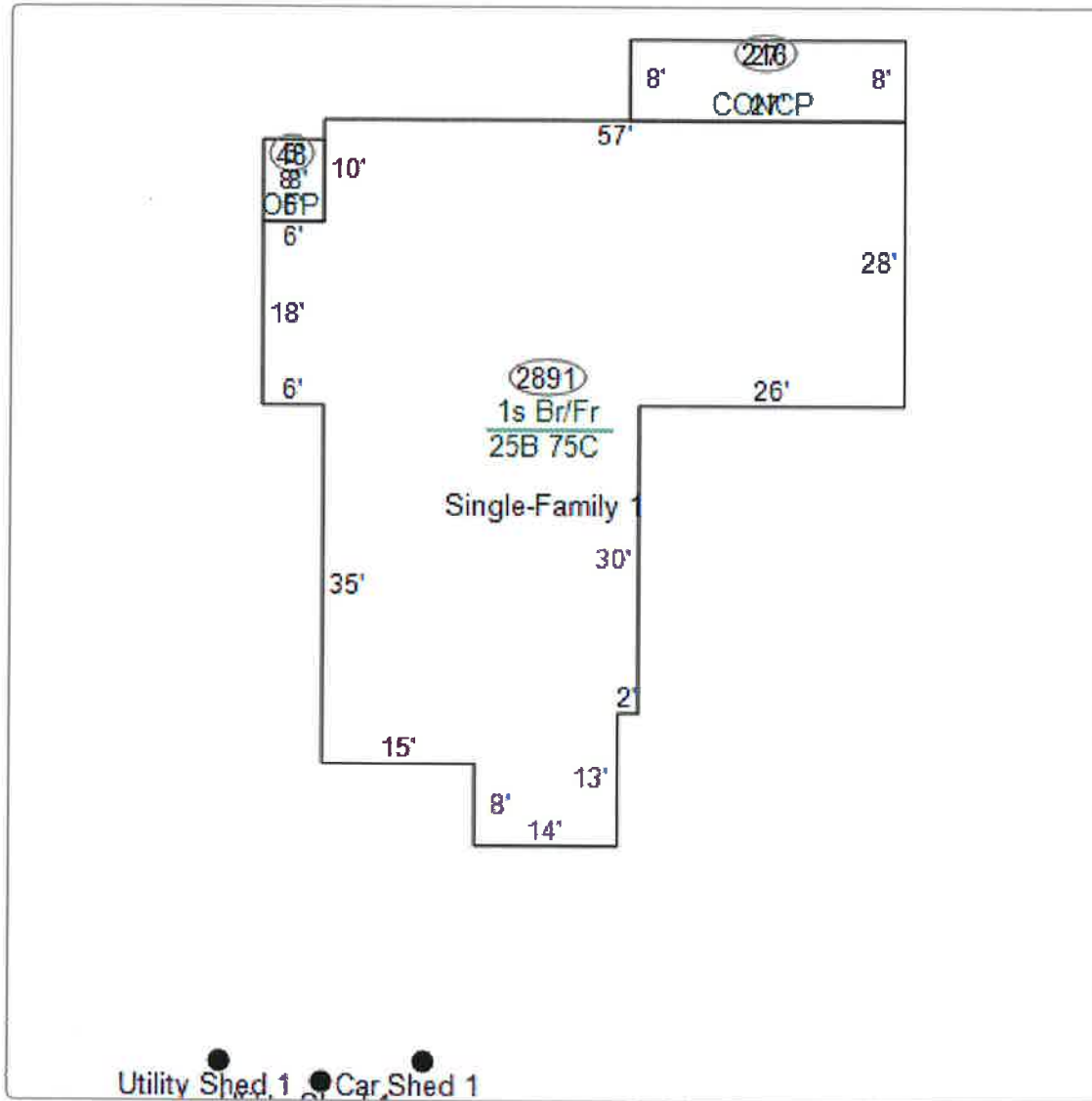

No data available for the following modules: Sales.

The information in this web site represents current data from a working file which is updated continuously. Information is believed reliable, but its accuracy cannot be guaranteed. No warranty, expressed or implied, is provided for the data herein, or its use.

Last Data Upload: 4/4/2017 10:16:07 PM



Developed by
The Schneider
Corporation